



**rortiza**<sup>®</sup>  
ROOFING SYSTEMS

Only available from

  
**SPACE AND STYLE**  
SPECIALIZED BUILDING MATERIALS  
*"Building Solutions You Can Trust"*



As the manufacturer of the world's original stone coated metal roof tile, we have used our expertise and experience to develop an alu-zinc roof tile with a coating of genuine natural stone at a price you can afford.

We believe that Fortiza® is the only roof tile which delivers this level of quality and affordability.

### We Will Work With You...

...To ensure that your new roof is exactly how you want. From choosing the right colour, to making sure it's delivered on time and on budget.

At Space & Style, we believe in partnerships to create a beautiful roof within your budget.

Your satisfaction is the most important thing to us, so we'll make sure we get it right.

Fortiza® roof tiles are only available from:





# Our Tiles Are Bigger

Fortiza® tiles cover 10% more than industry standard sized tiles. Using Fortiza® means you use less tiles per m<sup>2</sup> and less timber. Plus, with Fortiza®, you only use 2 tiles per m<sup>2</sup>.



	Fortiza® Tile	Fortiza® Shingle
Pitch (Min / Max)	15° / 90°	15° / 90°
Overall Length	1335mm	1330mm
Overall Width	440mm	425mm
Length of Cover	1250mm	1245mm
Width of Cover	400mm	400mm
Tiles per m <sup>2</sup>	2	2
Upstand	20mm	20mm
Roof Cover / Tile	1m <sup>2</sup> / 0.5m <sup>2</sup>	1m <sup>2</sup> / 0.5m <sup>2</sup>

## At A Glance

- 1 Alu-Zinc Steel
- 6 Fast Installation
- 2 Genuine Stone Coating
- 7 Fire Retardant
- 3 Colour That Will Not Change
- 8 Global Manufacturer
- 4 Full Range of Accessories
- 9 Secure Roof
- 5 Stock Available to Take Away
- 10 Written Warranty



Red



Green



Brown



Dark Grey



Clay

## Fortiza<sup>®</sup> Tile

Timeless and elegant, Fortiza<sup>®</sup> Tile has the scalloped profile of a traditional Mediterranean clay tile. Available in natural and contemporary roof colours, this profile will give your home a beautiful, aesthetically pleasing appearance.



# Fortiza® Shingle

Fortiza® Shingle gives traditional and contemporary homes a feeling of strength, solidity and importance. Inspired by rock, stone and wood, the profile is available in a selection of natural colours.



Brown



Dark Grey



Bruno (Patched)



Lava (Patched)



Storm (Patched)



# Strength. Beauty. Originality.

Every Fortiza® tile is a multi-layered configuration of high strength and unyielding composites, designed to work together in perfect balance.

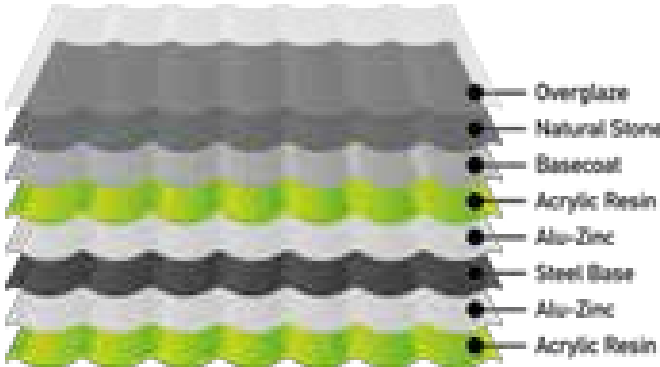

# Accessories

The Fortiza® Roofing System includes a full range of accessories, manufactured from the same high quality materials as our roofing tiles.

## Ridge Hip

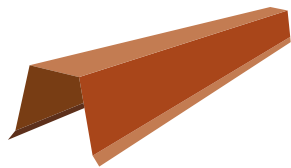

Overall Length 2000mm  
 Length of Cover 1900mm  
 Downturn 62mm  
 Width 35mm  
 Weight/UnitTexture 2.0kg

## Box Barge

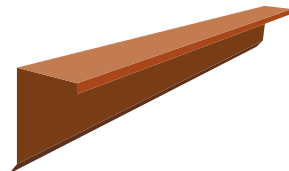

Overall Length 2000mm  
 Length of Cover 1900mm  
 Downturn 130mm  
 Width 70mm  
 Weight/UnitTexture 2.5kg

## Side Flashing

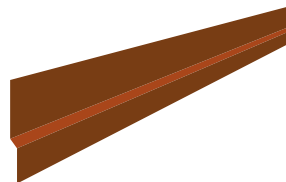

Overall Length 2000mm  
 Length of Cover 1900mm  
 Upturn 86mm  
 Width 17mm  
 Downturn 57mm  
 Weight/UnitTexture 1.4kg

## A Ridge

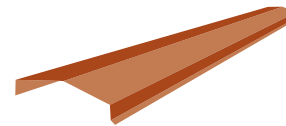

Overall Length 2000mm  
 Length of Cover 1900mm  
 Upturn 25mm  
 Width 160mm  
 Weight/UnitTexture 2.3kg

## Flat Sheet

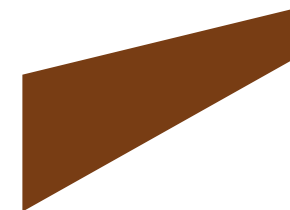

Overall Length 2000mm  
 Width 400mm  
 Weight/UnitTexture 3.9kg

## Combo Valley

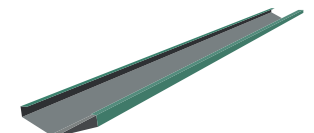

Overall Length 2400mm  
 Length of Cover 2250mm  
 Upturn 25mm  
 Width 160mm  
 Weight/UnitTexture 2.1kg

# Secure and Easy Installation

Because Fortiza® is a bigger tile and easier to work with, it is one of the quickest roofs to install. This means less labour costs and a shortened build time.

In addition, with each tile secured to the roof battens through the tile to the left, right, two tiles above and two tiles below, a Fortiza® roof is incredibly secure against both the weather and intruders.

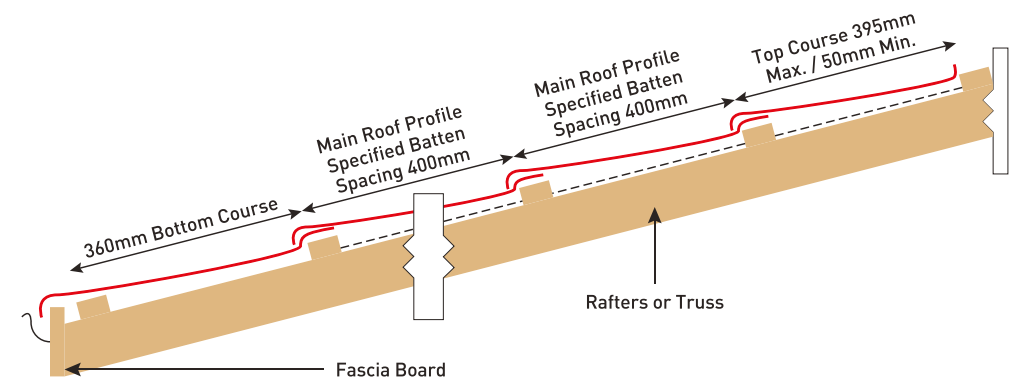



Adding Beauty and Value  
the Affordable Way

Fortiza® roof tiles are only available from:



**SPACE AND STYLE**

**SPECIALIZED BUILDING MATERIALS**

***“Building Solutions You Can Trust”***

**Head Office**

Libra House  
off Mombasa Road  
opposite Sameer Business Park  
Nairobi  
Kenya

0722 706 837  
info@spaceandstyle.co.ke

**Kisumu Office**

Hardware Dealers Building  
Oginga Odinga Street  
opposite Swan Centre  
Kisumu  
Kenya

0731 777 711  
kisumu@spaceandstyle.co.ke

**Mombasa Office**

P.J. Plaza Ground Floor  
Links Road  
Nyalı; adjacent to Shell  
Nyalı - Mombasa  
Kenya

0731 000 852  
mombasa@spaceandstyle.co.ke

**Thika Office**

Garissa Road  
opposite Total Petrol Station  
Thika  
Kenya

0731 000 235  
thika@spaceandstyle.co.ke

**Kitengela Office**

Tarikivile  
Kitengela  
Kenya

0731 000 234  
kitengela@spaceandstyle.co.ke

[www.spaceandstyle.co.ke](http://www.spaceandstyle.co.ke) | [www.facebook.com/spacestyle](https://www.facebook.com/spacestyle)